

# When your gas suddenly stops

Firstly, confirm safety and check why the gas shut off.

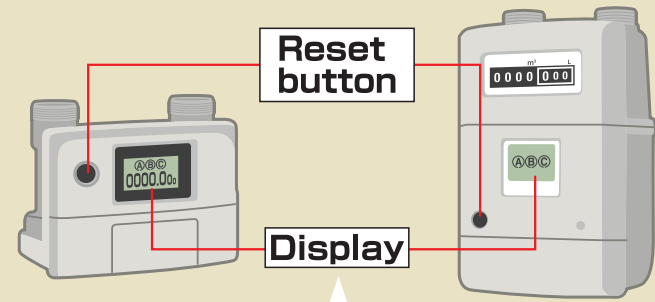

- B○C**  
ガス止  
When an earthquake of intensity 5 or greater occurs during gas use.
- A○C**  
ガス止  
When gas continues to be used for a long time, such as when an appliance hasn't been turned off.
- C**  
ガス止  
When there is quite a lot of gas flowing, such when a rubber hose has come off.

**If there is a gas leak or you smell gas, do not reset the gas meter as shown on the right. Contact your LP gas shop or the emergency contact address.**

- \* If gas was not in use, the gas supply is not shut off.
- \* If your gas is not usable after you complete the reset steps, do not repeat the reset procedure. Contact your LP gas shop for an inspection.

## Resetting the gas meter

**1**

- Close all appliance valves.
- Check that all unused gas valves are in the closed position.

**2**

- Press the reset button on the left side.
- The “ガス止 (Gas Supply Stopped)” message goes out.

**3**

- Letters on the LCD and the lamp begin flashing.
- Wait for **one minute**.

\* The reset button may have a lamp on some meters.

**4**

- The Letters on the LCD and the lamp go out.
- Reset is complete.
- Gas can be used again.

## Get your gas appliances inspected after 10 years.

Gas appliances that have been in use for long periods of time can cause accidents due to deteriorating parts. Once 10 years have passed, contact the manufacturer or dealer to request an inspection.

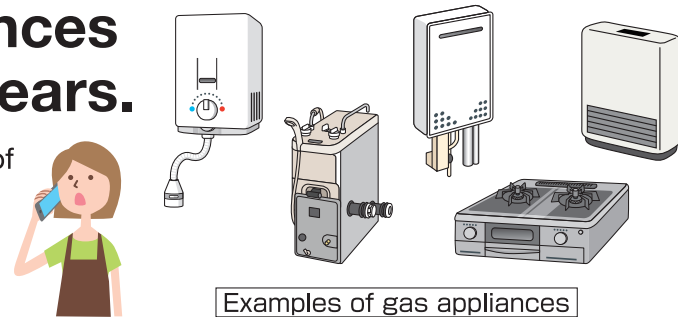

### Contact details in case of LP gas emergencies!

Contact address

Tel.

Contact in an emergency is available 24 hours a day.

### LP gas shop

# For safe and secure use

What should you do when you smell gas?

Please keep this guidebook in your kitchen, living room, or wherever your family can easily find it.



**Never use an ignition source.** Danger

- Never touch the switches of lights, ventilation fans, or other electrical appliances. These may spark and ignite fires.

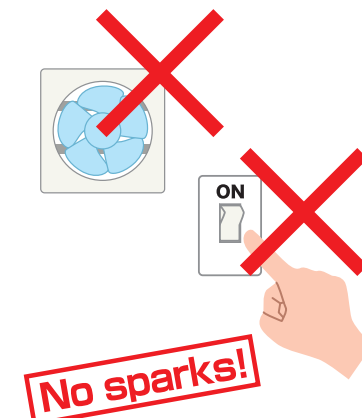

**Open windows and doors wide to flush out the gas.**

- Check for gas accumulating in low places. Remember that LP gas is heavier than air.



**Close all gas and appliances valves.**

- Be sure to close the gas meter valve or gas cylinder valve.



- If you don't know where the gas meter valve is located, check with your local LP gas shop in advance.

**Report the gas leak immediately.**

Follow the instructions of the emergency contact person.



- Do not use any gas until safety is confirmed.

- Check the emergency contact details of your local LP gas shop (for future reference).

- Contact in an emergency is available 24 hours a day.

# Safety check points

## ✓ To prevent carbon monoxide (CO) poisoning!

### Check ventilation

- Make a habit of ensuring ventilation when using gas appliances.

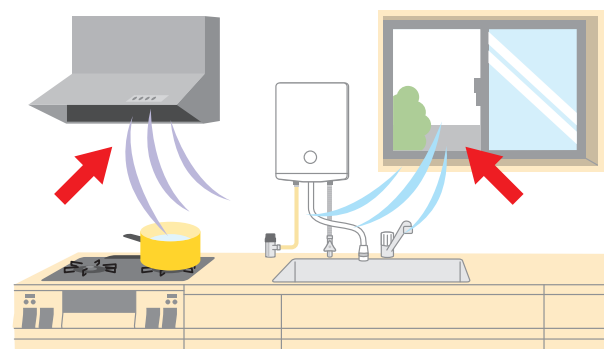

#### To users of gas heaters and gas fan heaters

Be sure to open a window to ventilate for a few minutes once or twice every hour.

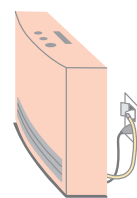

### Combustion appliances which intake and exhaust directly outdoors

- Is the exhaust pipe detached?
- Is the exhaust port blocked?
- Is the end of the exhaust pipe set outdoors?

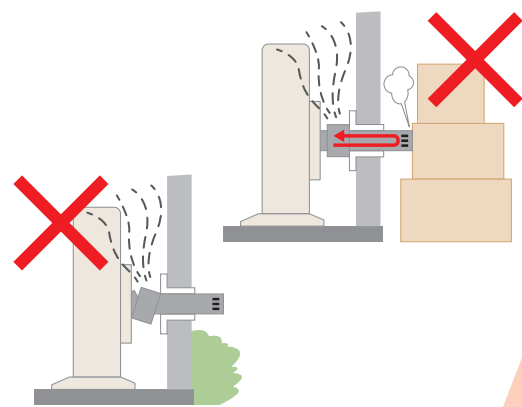

## ✓ To prevent gas leaks!

### Check the ignition Repeated ignition/re-ignition Going out

- Accidents will occur if you fail to confirm proper ignition. Be sure to check visually!
  - Accidents occur when gas accumulates in an appliance after repeated failures at ignition. Always be careful when attempting to ignite a gas appliance after failing the first few times.
- \* Is the battery dead?

### Unused gas valves

- Is the knob turned off fully?
- Is the gas valve covered with a rubber cap?

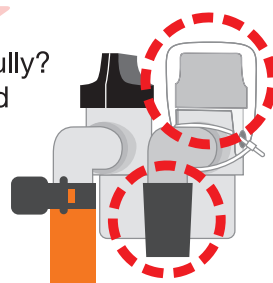

### Rubber hose

- Are there any burn marks or cracks?
- Does the hose reach the red line on the gas valve?
- Is the hose firmly fastened with a hose band?

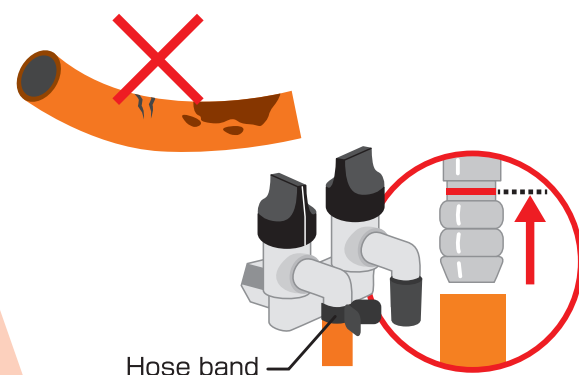

## What is carbon monoxide (CO) poisoning!



If you use a gas appliance in an environment without sufficient air (oxygen), the appliance will generate carbon monoxide due to incomplete combustion. Carbon monoxide is extremely toxic. Inhaling even small amounts can lead to the risk of death. Installing a CO detection device is recommended.

## ✓ Just in case...!

### CO alarm Gas leak alarm

- Be sure to plug the alarm back into the plug outlet after using a vacuum cleaner, etc.
- Is the plug detached?



Example of a gas alarm



Example of a CO alarm

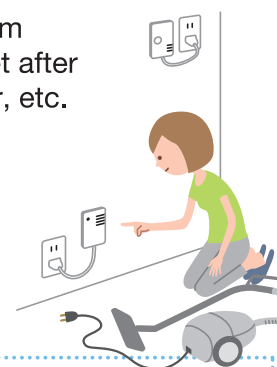

By installing a gas alarm or CO alarm, you'll have peace of mind because you'll be alerted by a buzzer or voice message when there is gas trouble.

\* **CO alarms should be replaced every 5 years.**

### LP gas cylinders

- The installation site should be at least 2 meters away from any ignition source.

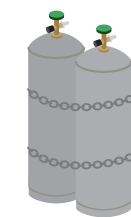

### Recommended steps to prevent snow damage

- Regulators or gas meters can be damaged by snow. Please use a snow fence or check the cylinder hut.
- When removing snow from a roof, take care to avoid damaging LP gas equipment.

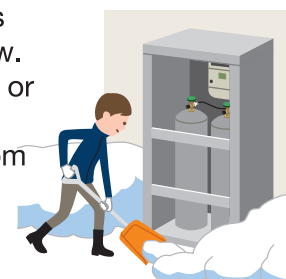

## Always contact your local LP gas shop when...

### Flame

Flame is unstable Flame is yellow

Some sections have no flame

### Operation

Flame goes out during use

Flame flares up or explodes on ignition

Fire does not spread smoothly

Flame does not catch evenly

Doesn't ignite

### Appliance

Abnormal noise as flame burns

A smell of gas

A smell of exhaust gas during operation

Request an inspection from the appliance manufacturer or your LP gas shop immediately.

